

# Fire-resistant doors made of wood and steel

EI30 in steel and stainless steel





**forster fuego<sup>®</sup>light**

## The elegant material mix for fire protection doors EI30

Fire-resistant door EI30

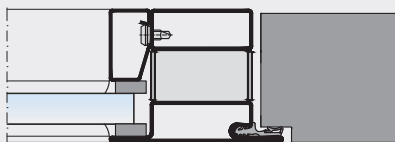

Door variants with sidelights and fanlights

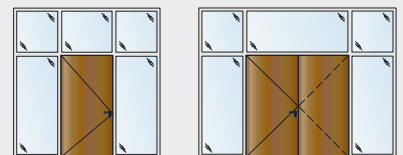

Color catalogs:

<http://www.argolite.ch/kollektionen>

<http://www.fundermax.at/interior/dekore.html>

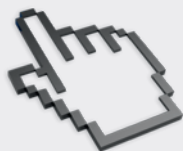

The door specialists RWD Schlatter and Forster Profile Systems have created a mix in a class of its own: a fire-resistant door made of wood and steel or stainless steel. The warmth of wood and the cool elegance of the steel can be combined in different appearances for demanding safety applications indoors.

Combinations with sidelights and fanlights are in different variants possible. Especially for hospitals, residential and care homes, schools, reception areas, offices or conference rooms, this door is the ideal choice. In short: it is suitable wherever aesthetic aspects have a high priority and reliable protection is required.

- single and double leaf doors
- frame construction depth 65 mm
- flush frame and door leaf on both sides
- concealed hinges, door closer and carry bar
- also in fire-resistant glazings EI30 and EI60
- frame profiles in steel or stainless steel
- large selection of colors and materials for the door leaf surface
- also available with priming film for custom painting



## Technical details

Material options	Steel
	Stainless steel 1.4301
	Wooden door leaf with surface options in a huge variety of colors and materials
Performance specifications*	Fire-resistance according to EN 1634-1
	Switzerland:
	VKF 21970 / 1 leaf door in EI30/EI60 glazing
	VKF 12696 / 2 leaf door in EI30/EI60 glazing
	other construction variants on demand
System properties	Germany: test for approval in progress
	France: test for approval in progress
	Sound insulation $R_w = 37$ dB
	RWD-Schlatter standard fittings
	Also with panic push-bar
Dimensions	Concealed hinges (applied door closer on demand)
	1-leaf maximum 1320 × 2640 mm
	2-leaves maximum 2640 × 2640 mm

\*refer to country-specific approvals

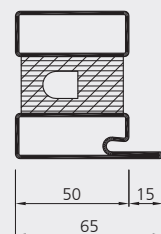

735.400/T

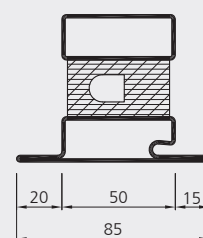

735.403/T

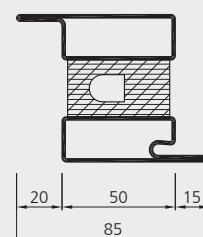

735.405/T





*Fire-resistant doors EI30  
Hospital, Münsterlingen, Switzerland*

Forster Profile Systems Ltd.  
P.O. Box 400  
CH-9320 Arbon  
Tel. +41 71 447 43 43  
[forster.profile@afg.ch](mailto:forster.profile@afg.ch)  
[www.forster-profile.ch](http://www.forster-profile.ch)

**forster**  
A leading brand of  **AFG**